



Signature Module Installation Instructions

US Patent #8,769,878

Models SM-101 and SM-102

SM-101 - T3 (DC) Edges SM-102 T2 (10K0) Edges



WARNING – To reduce the risk of severe injury or death:

Parts List:

- Signature Module (SM)
- Wire Nuts (4)
- Instruction Manual (1)
- Junction Box (1)

1. **READ AND FOLLOW ALL INSTALLATION INSTRUCTIONS**
2. Disconnect all power before beginning any work.
3. Do not reconnect the opener to source of power until instructed to do so.
4. Test the system when installation is completed.
5. Follow all local and national electrical codes.

See Step - By - Step Installation Guide on Reverse Side

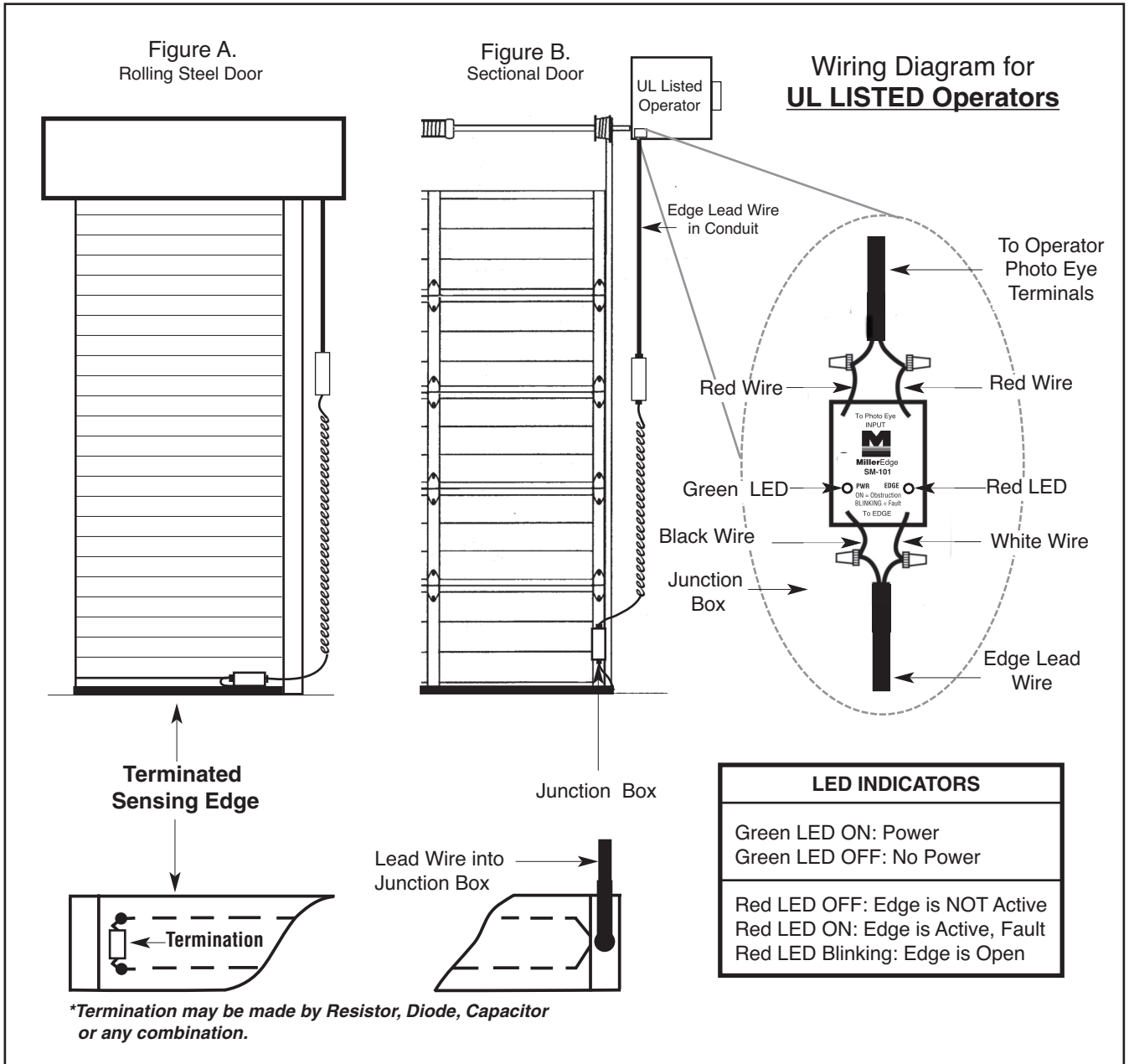

STEP-BY-STEP INSTALLATION GUIDE



- 1- Mount the Sensing Edge as per the edge installation instructions.
- 2- Place the Signature Module inside the UL Listed operator.
- 3- Connect the Black & White wires from the Sensing Edge to the Black & White wires of the Signature Module.
- 4- Connect the RED wires from the Signature Module to the Operator. ¹

TEST SYSTEM

- 1- Reapply power to the operator.
- 2- The RED LED on the Signature Module should be OFF if the safety edge is not active.
- 3- Open the door slightly.
- 4- Apply pressure to the Safety Edge, the RED LED on the Signature Module should go ON.
- 5- Door should open.

*** If any steps fail, check all connections.**

TROUBLE SHOOTING TIPS

LED Color	STATUS	DIAGNOSIS	CAUSE / SOLUTION
GREEN	ON	Power	Normal Operation
	OFF	No Power	Check the wire connection between the Operator and the Signature Module.
RED	OFF	Edge is Not Active	Normal Operation
	ON	Edge is Active, Fault	Edge is hit
	BLINKING	Edge is Open, Fault	Check the wire connection between the Edge and the Signature Module. Edge is faulty or not proper for this application

Note 1 : All interconnecting wiring between the Signature Module and the operator is required to be Listed Power-Limited Circuit Cable Type CL2, CL2P, CL2R, or CL2X depending on the application as described in article 725 of ANSI/NFPA 70, "National Electric Code" (NEC) in accordance with UL325.

SM101-SM102_Inst_20140822